



THE OLD SWAN HOTEL

Your meeting and event venue in the heart of Harrogate



- Conferences for up to 450
- 9 meeting rooms
- Training days
- Interviews
- Corporate fun days
- Seminars
- Private dining
- Launches and presentations
- Team building

Built in 1840 and one of Harrogate's finest hotels, The Old Swan Hotel combines a warm, traditional hospitality with contemporary comfort and extremely flexible meeting space, all set in 5½ acres of private gardens.

Located in the heart of this historic Spa town, and on the edge of the Yorkshire Dales, the hotel was the famous retreat of crime queen Agatha Christie who famously 'disappeared' here in 1926. It was subsequently the location for the film *Agatha* starring Dustin Hoffman and Vanessa Redgrave in 1977. The hotel retains the elegance and splendour of a former era and is the ideal atmosphere to impress clients and conduct important business events.

Easily accessible from the main motorway network, the Old Swan has ample parking space and is a five minute walk to the centre of town with the Harrogate International Centre, Pump Rooms, gardens, shopping and tea rooms.

Nine conference rooms of varying sizes can accommodate your meeting or event perfectly and all include full business support facilities. The hotel has 136 bedrooms, including suites with private sitting rooms, and our Wedgwood Restaurant and private dining rooms serve an excellent dinner at the end of a busy business day.

Our Conference and Banqueting team can tailor-make your event to match your precise requirements, including team-building itineraries, and we will be on hand to make sure that everything runs smoothly. Call us to discuss your plans.

- 136 en-suite bedrooms, including 10 suites
- Naturally-lit conference suites
- Competitive day and 24-hour delegate rates
- Business services
- Private dining
- 24 hour technical support
- 5 acres of private gardens
- Free parking for up to 175 cars
- 7 miles from the A1M and 14 miles from Leeds/Bradford International Airport
- 5 minutes' walk from the Harrogate International Centre



THE OLD SWAN HOTEL

Your meeting and event venue in the heart of Harrogate

Room Details

Room Name	Garden Room & Ballroom*	Garden Room*	Ballroom*	Red Lounge*	Rose Room*	Penthouse ⁴	Bramham Suite*	Foxhunter Suite*	Wedgewood Room*
Dimensions									
Length	32.4	5.9	16.5	11.0	11.9	10.3	13.4	14.0	23.4
Width	14.3	14.3	11.0	9.7	8.8	9.7	7.6	5.8	16.7
Height	4.8	3.9	4.8	4.2	4.2	3.0	3.9	3.6	5.8
Capacities									
Theatre	450	300	300	90	90	70	30	50	-
Classroom	200	130	130	50	50	40	20	30	-
Boardroom	-	100	100	30	30	30	20	25	-
U Shape	-	100	100	30	30	30	10	25	-
Cabaret	260	140	105	50	50	50	20	35	-
Banquet	380	150	200	80	80	-	50	50	250
Dinner Dance	330	130	140	50	50	-	30	30	220
Springs Layout	450	266 ^o	144 ^o /216 ^o	-	-	-	-	-	-
Reception	750	450	300	100	100	100	50	50	500
Power									
No. 13 amp sockets	14	7	7	4	6	6	10	9	20
3-phase power	Yes	Yes	Yes	No	Yes	No	No	No	Yes
Access									
Wheelchair Access	Yes	Yes	Yes	Yes	Yes	No	Yes	Yes	Yes
External access	Yes	Yes	No	Yes	No	No	No	No	No
Access door	2.6 x 2.3	2.6 x 2.3	2.1 x 2.3	2.4 x 1.1	2.4 x 2.1	2.4 x 1.5	2.2 x 1.6	2.3 x 1.0	2.3 x 2.1

^oNo dancefloor | ^oWith dancefloor | *Ground Floor | ⁴Mezzanine Floor

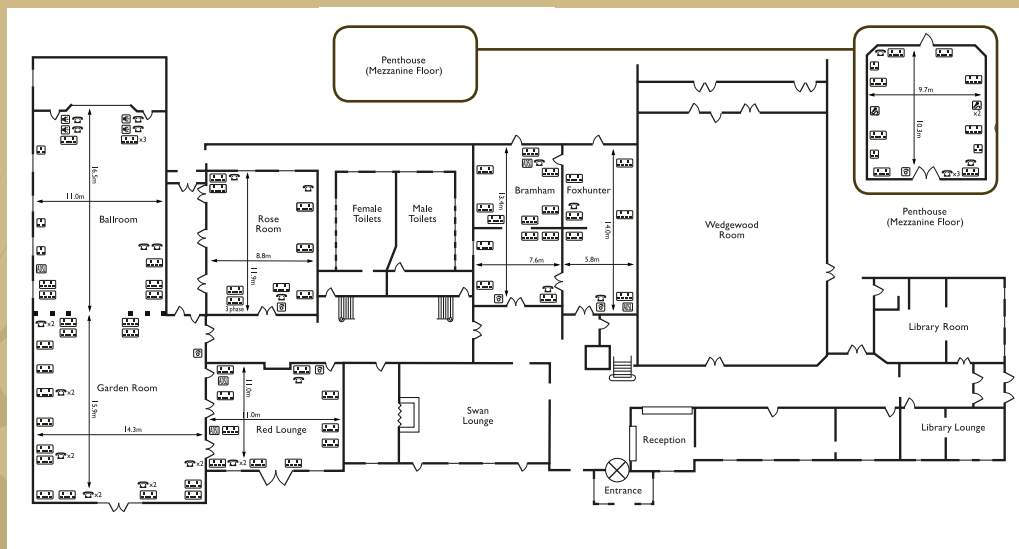

Our Facilities:

The hotel has 9 meeting rooms for your conference requirements. The Ballroom/Garden Room, with its beautifully-restored vaulted ceiling, can accommodate up to 450 delegates, and 380 for a private dinner. Doors open onto the gardens.

The splendid Wedgewood Restaurant can accommodate up to 200 for a private dinner. It features wood panelling, a stained glass ceiling, impressive pillars and unique corning.

The Red Lounge and Rose Room will each hold up to 90 people for a conference or 70 for a private dinner. Naturally-lit, these rooms have high ceilings and elegant original features.

The Penthouse is a private room on a mezzanine level capable of seating 70 for a conference.

The Foxhunter Suite and The Bramham Suite are ideal for smaller boardroom meetings.

By Road:

From the South: M1 to A1 to Wetherby, then exit onto A661 to Harrogate. Follow signs to Ripon and town centre. Drive down Parliament Street, straight across the traffic lights at the bottom, and up Ripon Road. After approximately 150 yards, turn left into Swan Road.

From the West: M62 to A1 to Wetherby, then exit onto A661 to Harrogate. Follow signs to Ripon and town centre. Then as above.

From the North: A1 to A61 signed for Ripon and Thirsk. Follow signs to Ripon. Follow signs to Harrogate, through Ripley and Killinghall. Take 2nd exit off roundabout onto Ripon Road. After approx. 1 mile, turn right into Swan Road.

How to find us:

By Rail:

Harrogate Station 1 mile

By Air:

Leeds/Bradford International Airport 14 miles

Robin Hood Airport 50 miles

Teesside Airport 52 miles

Manchester Airport 72 miles



For further details on our facilities, please go to www.classiclodges.co.uk/theoldswan

The Old Swan Hotel, Swan Road, Harrogate, North Yorkshire HG1 2SR

email: conference.oldswan@classiclodges.co.uk | call: 01423 500055 | www.classiclodges.co.uk/theoldswan